

**Dishwasher
Instruction Manual
DWD53FI**



A AWARD

CONTENTS

Technical specifications	5
• Conformity with the standards and Test data	5
Safety information and Recommendations	6
• Recycling	6
• Safety information	6
• Recommendations	9
• Items not suitable for dishwashing	9
Installing the machine	10
• Positioning the machine	10
• Water connections	11
• Water inlet hose	12
• Water outlet hose	12
• Electrical connection.....	13
Preparing the machine for use	14
• Prior to using the machine	14
• Detergent usage	14
• Filling the detergent compartment.....	14
• Combined detergent.....	15
• Filling with rinse aid and making the setting.....	16
Loading your dishwasher	17
• Alternative basket loads	22
Programme descriptions	23
• Programme items	23
Getting familiar with your machine	24
• Switching on the machine.....	27
• Programme follow-up	27
• Changing a programme	28
• Changing a programme with resetting	28
• Switching the machine off	29

Maintenance and Cleaning	32
• Filters	32
• Spray arms	33
• Hose filter	33
Failure codes and what to do in case of failure	34
Practical and useful information.....	37

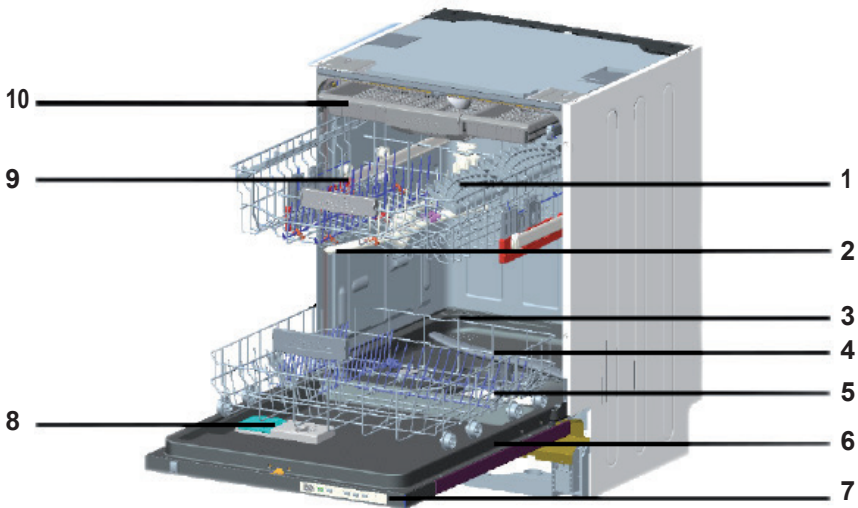

11



12



13

- 1. Upper basket with racks
- 2. Upper spray arm
- 3. Lower basket
- 4. Lower spray arm
- 5. Filters
- 6. Rating plate
- 7. Control Panel
- 8. Detergent and rinse-aid dispenser
- 9. Upper basket track latch
- 10. Upper Cutlery Basket
- 11. **Ceiling Spray Arm:** It provides a better wash for the dishes in the upper basket.
- 12. **Turbo Drying Unit:** This system provides a better drying performance for the dishes.
- 13. **Interior light :** Provides illumination to give a better view when placing dishes in the unit.

Technical specifications

Capacity	15 place settings
Height	820 mm - 870 mm
Width	598 mm
Depth	550 mm
Net Weight	38 kg
Electricity input	220-240 V, 50 Hz
Total Power	1900 W
Heating Power	1800 W
Pump Power	100 W
Drain Pump Power	30 W
Water supply pressure	0.03 MPa (0,3 bar)-1 MPa (10 bar)
Current	10 A

SAFETY INFORMATION AND RECOMMENDATIONS

Recycling

- Recyclable materials are used in certain components and packaging.
- Plastic parts are marked with international abbreviations: (>PE< , >PS< , >POM<, >PP<,)
- Cardboard parts have been produced from recycled paper which should be disposed of into waste paper collection containers for recycling.
- Such materials are not suitable for garbage bins. They should be delivered to recycling centres instead.
- Contact the relevant centre in order to obtain information on methods and points of disposal.

Safety Information

When you take delivery of your machine

- If you see any damage on your machine's packaging, please notify your retailer.
- Unwrap the packaging materials as indicated and dispose of them in accordance with the rules.

Points to pay attention to during machine installation

- Choose a suitable, safe and level place to install your machine.
- Carry out the installation and connection of your machine by following the instructions.
- We recommend that the machine is installed by an authorised installer, and should only be serviced by an approved technician.
- Only original spare parts should be used with the machine.
- Before installing, be sure that the machine is unplugged.
- Check whether the indoor electrical fuse system is connected according to regulations.
- All electrical connections must match values on the rating

plate.

- Be sure that the machine does not stand on the electricity supply cable.
- Never use an extension cord or a multiple socket for making a connection. The plug should be comfortably accessible after installation.
- After installation, run it unloaded for the first time.

In daily use

- This machine is for domestic use; do not use it for any other purpose. Commercial usage of the dishwasher see warranty card.
- Do not get up, sit or place a load on the open door of the dishwasher, it may fall over.
- Never put into the detergent and rinse aid dispensers of your machine anything other than those detergents and rinse aids which are produced specifically for dishwashers. Our company will not be responsible for any damage that might occur in your machine otherwise.
- The water in the machine's washing section is no drinking water do not drink it.

Warning: Some dishwasher detergents are strongly alkaline. They can be extremely dangerous if swallowed. Avoid contact with the skin and eyes and keep children away from the dishwasher when the door is open. Check that the detergent receptacle is empty after completion of the wash cycle.

- Due to danger of explosion, do not put into the machine's washing section any chemical dissolving agents such as solvents.
- Check whether plastic items are heat-resistant before washing them in the machine.
- This appliance is not intended for use by persons (including children) with reduced physical, sensory or mental capabilities, or lack of experience and knowledge, unless they have

been given supervision or instruction concerning use of the appliance by a person responsible for their safety.

- Children should be supervised to ensure that they do not play with the appliance.
- Do not put into your machine those items which are not suitable for dishwashing. Also, do not fill any basket above its capacity. Our company will not be responsible for any scratch or rust to form on the inner frame of your machine due to basket movements otherwise.
- Especially because hot water may flow out, the machine door should not be opened under any circumstances while the machine is in operation. In any case, a safety device ensures that the machine stops if the door is opened.
- Do not leave the dishwasher's door in the open position since this could present a tripping hazard.

Warning: Knives and other utensils with sharp points must be loaded in the basket with their points down or placed in a horizontal position.

- If the supply cord is damaged, it must be replaced by the manufacturer, its service agent or similarly qualified persons in order to avoid a hazard.
- If EnergySave option is selected as "Yes", The door will be opened at the end of the program. Do not force the door closed to avoid harm to the auto door mechanism for one minute. The door must be open for 30 minutes to get effective drying. (in models with auto door opening system)

Warning: Do not stand in front of the door after the signal sounds belonging auto-open.

For your children's safety

- After removing the machine's packaging, make sure that the packaging material is out of reach of children.
- Do not allow children to play with or start the machine.
- Keep children away from detergents and rinse aids.

- Keep children away from the machine while it is open because there may still be residues of cleaning substances inside the machine.
- Be sure that your old machine does not pose any threat to your children. Children have been known to get themselves locked in old machines. To prevent such a situation, break your machine's door lock and tear off the electrical cables.

In case of malfunctioning

- Any repairing performed by anyone other than authorized service personnel will invalidate your warranty.
- Prior to any repair work on the machine, be sure that the machine is isolated from the mains. Switch off the fuse or unplug the machine. Do not pull by the cable when unplugging. Make sure to turn off the water tap.

Recommendations

- For energy and water saving, remove coarse residues on your dishes before placing the dishes into the machine. Start your machine after having fully loaded it.
- Use the pre-wash programme only when necessary.
- Place such hollow items as bowls, glasses and pots into the machine in such a way that they will face down.
- You are not recommended to overload your machine or load it in a way other than that which is indicated.

Items not suitable for dishwashing:

- Cigarette ashes, candle leftovers, polish, paint, chemical substances, iron-alloy materials;
- Forks, spoons and knives with wooden or bone, or ivory or nacre-coated handles; glued items, items soiled with abrasive, acidic or base chemicals.
- Plastic items that are not heat-resistant, copper or tin-coated containers.
- Aluminium and silver objects (they may discolour, become dull).

- Certain delicate glass types, porcelains with ornamental printed patterns as they fade even after the first wash; certain crystal items as they lose their transparency over time, adhered cutlery that is not heat-resistant, lead crystal glasses, cutting boards, items manufactured with synthetic fibre;
- Absorbent items as sponges or kitchen rags are not suitable for dishwashing.

Warning: Take care to buy dishwasher-proof sets in your future purchases.

INSTALLING THE MACHINE

Positioning the machine

When determining the installation place, choose an accessible place for easy loading and unloading of the dishes.

Do not put your machine in any location where there is the probability for the room temperature to fall below 0°C.

Before positioning, take the machine out of its packaging by following the warnings located on the package.

Position the machine close to a water tap or drain. You need to site your machine, taking into consideration that its connections will not be altered once they are made.

Do not grip the machine by its door or panel in order to move it.

Take care to leave a certain clearance from all sides of the machine for moving comfortably back and forth during cleaning.

Make sure that the water inlet and outlet hoses do not get squeezed while positioning the machine. Also, make sure that the machine does not stand on the electrical cable.

Adjust the machine's adjustable feet so that it can stand level and balanced. Proper positioning of the machine

ensures problem-free opening and closing of the door. If the door of machine does not close properly, check if the machine is stable on the floor; if not, adjust the feet and ensure its stable position.

Water connection

Indoor plumbing must be suitable for installing a dishwasher. Also, we recommend that you fit a filter at the entrance of your place or apartment so as to avoid any damage to your machine because of any contamination (sand, clay, rust etc.) that might be occasionally carried in through the mains water supply or the indoor plumbing, and to prevent such complaints as yellowing and formation of deposits after washing.

Water inlet hose

Do not use the water inlet hose of your old machine. Use the new one supplied with your machine instead. If you will connect a new or long - unused water inlet hose to your machine ,run water through it for a while before making the connection. Connect the water inlet hose directly to the water inlet tap. The pressure supplied by the tap should be at a minimum of 0.03 Mpa and and at a maximum of 1 Mpa.If the water pressure is above 1 Mpa,a pressure-relief valve should be fitted inbetween.

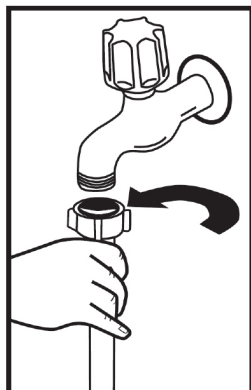

After making connections, the tap should be turned on fully and checked for water tightness.For the safety of machine, turn off the water inlet tap after finishing each wash programme.

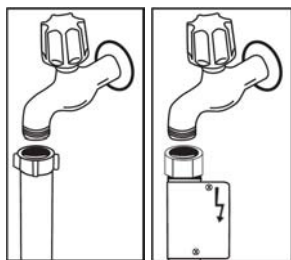

NOTE: Aquastop water etc. spout is used in some models. In case of using Aquastop, a dangerous tension exists. Do not cut the Aquastop water spout. Do not let it get folded or twisted.

Water outlet hose

The water drain hose can be connected either directly to the water drain hole or to the sink outlet spigot. Using a special bent pipe (if available), the water can be drained directly into the sink via hooking the bent pipe over the edge of the sink. This connection should be between 50 and 110 cm from the floor plane.

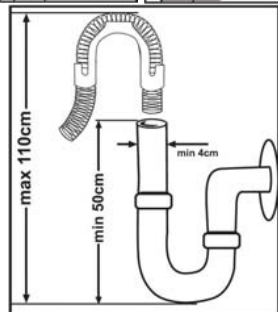

Warning: When a drain hose longer than 4 m is used, the dishes might remain dirty. In that case, our company will not accept responsibility.

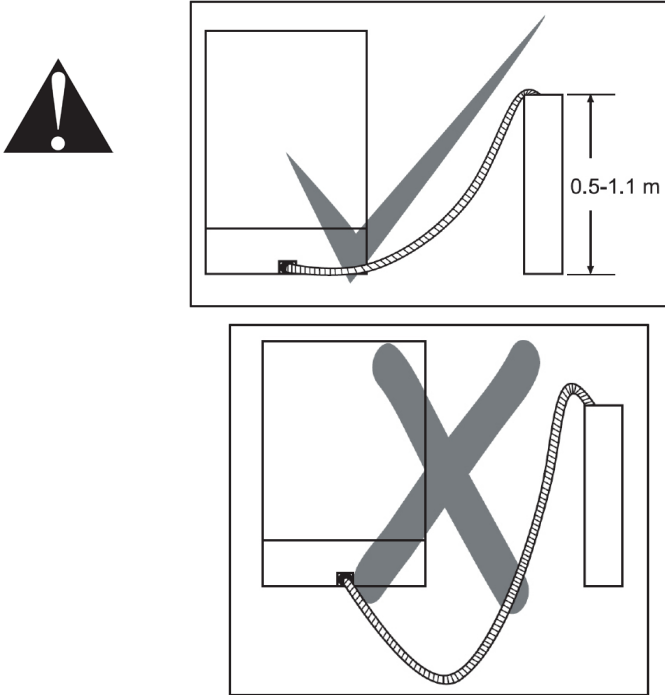

Electrical connection

The earthed plug of your machine should be connected to an earthed outlet supplied by suitable voltage and current. If there is no earthing installation, have a competent electrician to carry out it. In case of usage without earthing installed, our company will not be responsible for any loss of usage that might occur.

The indoor fuse current value should be 10-16 A.

Your machine is set according to 220-240 V. The machine should not be plugged in during positioning.

Always use the coated plug supplied with your machine.

Running in low voltage will cause a decline in washing quality. The machine's electrical cable should be replaced by an

authorised service or an authorised electrician only. Failure to do so may lead to accidents.

For safety purposes, always make sure to disconnect the plug when a wash. In order not to cause an electric shock, do not unplug when your hands are wet.

When disconnecting your machine from the mains supply, always pull from the plug. Never pull the cord itself.

PREPARING THE MACHINE FOR USE

Prior to using the machine for the first time

- Check whether the electricity and supply water specifications match the values indicated by the installation instructions for the machine.
- Remove all packaging materials inside the machine.
- Set the water softener.
- Fill the rinse aid compartment.

Detergent usage

Use a detergent specifically designed for use in domestic dishwashers.

You can find powder, gel, and tablet detergents that have been designed for household dishwashers.

Detergent should be put into the compartment prior to starting the machine. Keep your detergents in cool, dry places out of reach of your children.

Do not fill detergent into the detergent compartment more than required; otherwise it may cause scratches on your glasses as well as lead to a poorly dissolved detergent.

Should you need more information concerning the detergent you will use, contact detergent manufacturers directly.

Filling the detergent compartment

Push the latch to open the detergent container as shown in the image.

1 The detergent pod has level lines inside. The detergent pod can take totally 40 cm³ detergent. Open the dishwasher detergent and pour into the larger compartment **b** 25 cm³ if dishes are heavily soiled or less 15 cm³. **2** If dishes have been kept dirty for a very long time, dried food wastes on them or overly loaded the dishwasher, pour **a** 5cm³ detergent into the prewash compartment and start machine. You may have to add more detergent into your machine, depending

on the degree of soil and on the water hardness level in your area.

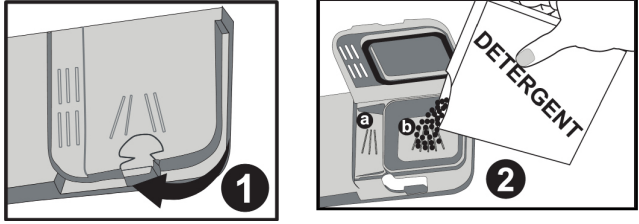

Combined detergents

Combined detergents may include various properties. Before using the detergent, read the instructions carefully. Generally combined detergents produce sufficient results under certain conditions only.

Points to consider when using this type of products:

- Check the specifications of the product whether it is combined or not.
- Check if the detergent used is appropriate for the hardness of mains water.
- Observe the instructions of products on packagings.
- Always put the tablets into the detergent compartment in the detergent dispenser.
- You need to contact the manufacturers and find out about the suitable conditions of use.
- If you use appropriate products, they ensure savings in salt and/or rinse aid consumption.
- The scope of warranty for your machine does not cover any complaints caused by the use of these types of detergents.

Recommended usage: If you want to obtain better results while using combined detergents, add salt and rinse aid into your machine and adjust the water hardness setting and the rinse aid setting to the lowest position.



Solubility of the tablet detergents produced by different companies can vary depending on the temperature and time. Therefore, it is not recommended to use such detergents in short programs. It is more suitable to use powder detergents in such programs.

Warning: Should any problem, which you have not encountered before arise with the use of this type of detergents, contact the detergent manufacturers directly.

When you stop using combined detergents

- Fill the salt and rinse aid compartments.
- Adjust the water hardness setting to the highest position and run an empty-wash.
- Adjust the water hardness level.
- Make the suitable rinse aid setting.

Filling with rinse aid and making the setting

Adequate amount of rinse aid prevents white water drops, lime stains, white film stripshaped. It also increases drying performance.

To put rinse aid, remove the rinse aid compartment cap by turning it. 1 Fill the rinse aid compartment with rinse to add rinse aid level indicator becomes dark; 2 refit the cap and close it by turning it in a way that the nails, correspond to one another. By checking the rinse aid level indicator on the detergent dispenser, you can understand whether or not your machine needs rinse aid. A dark indicator **b** means that there is rinse aid in the compartment, while a light indicator **a** shows that you need to fill the compartment with rinse aid.

The rinse aid level adjuster can be set to a position between 1 and 6. Factory setting for rinse aid is the position **3**.

You need to increase the degree of the adjuster if water stains form on your dishes after a wash, whereas you need to decrease the degree if a blue stain is left when wiped by hand. 3

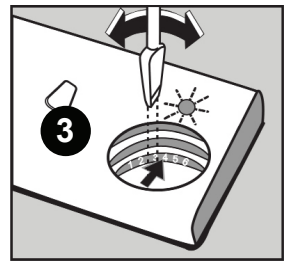
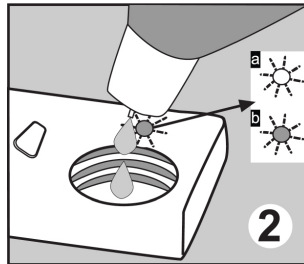
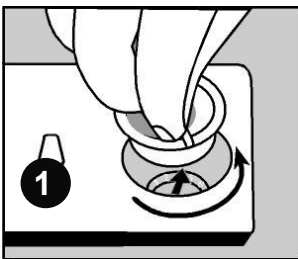

Warning: Use only those rinse aid materials which are allowed for use in the machine. As rinse aid residues left as a result of overflowing will create extremely high amounts of foam and thus reduce the washing performance, remove the excess amount of rinse aid by wiping it with a rag.

LOADING YOUR DISHWASHER

If you properly place your dishes into the machine, you will be using it in the best way in terms of energy consumption, washing and drying performance.

There are two separate baskets for you to load your dishes into your machine. You can load into the lower basket such round and deep items as pots with long handles, pot lids, plates, salad plates, cutlery sets.

The upper basket has been designed for tea plates, dessert plates, salad bowls, cups and glasses. When placing long-stem glasses and goblets, lean them against the basket edge, rack or glass supporter wire and not against other items. Do not lean long glasses against one another or they cannot remain steady and may receive damage. It is more appropriate to locate the thin narrow parts into the middle sections of baskets.

You can place spoons among the other cutlery sets in order to prevent them from sticking to one another. You are recommended to use the cutlery grid in order to obtain the best result.

To avoid any possible injuries, always place such long-handle and sharp-pointed dishes as serving fork, bread knife etc. with their sharp points facing down or horizontally on the baskets.

Warning: Place your dishes into your machine in a way that they will not prevent the upper and lower spray arms from spinning.

Top basket

Height Adjustable Rack

These racks are designed to increase the capacity of the top basket. You can place your glasses and cups on the racks. You can adjust the height of these racks. Thanks to this feature, you can place different sizes of glasses under these racks. Thanks to height adjustment plastics mounted on the basket, you can use your racks in 2 different heights. In addition, you can place long forks, knives and spoons on these racks laterally, so that they do not block the revolution of propeller.

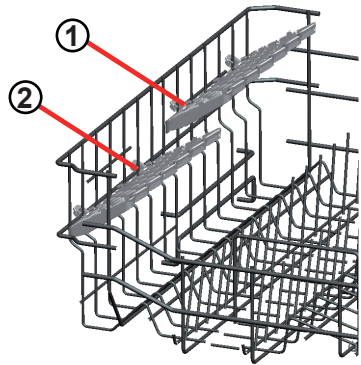

Foldable racks on the upper basket are designed in order to let you place big items easier such as pots, pans, etc. If requested, each part can be folded separately, or all of them can be folded and larger spaces can be obtained. You can use foldable racks by raising them upwards, or by folding down. Foldable racks on the upper basket are designed in order to let you place big items easier such as pots, pans, etc. If requested, each part can be folded separately, or all of them can be folded and larger spaces can be obtained. You can use foldable racks by raising them upwards, or by folding down.

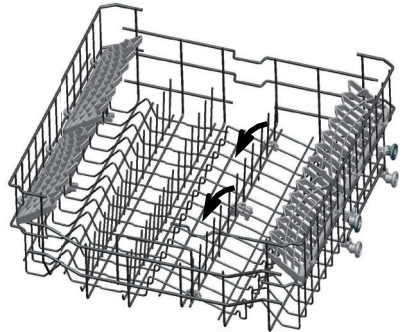

Top basket height adjustment while it is full

Basket height adjustment mechanism on the top basket of your machine is designed to let you adjust the height of your top basket upwards or downwards, without removing it from your machine when it is full, and create large spaces at the top or bottom area of your machine as needed. Basket of your machine is set to upper position in factory settings.

In order to raise your basket, hold it from both sides and pull it upwards. In order to lower it, hold it from both sides again, and leave it.

In loaded basket adjustment mechanism, make sure that both sides are in the same position (up or down).

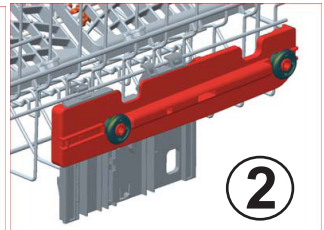
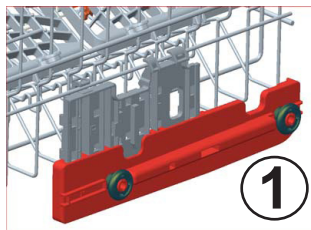
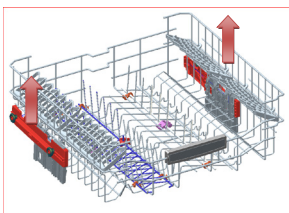

Lower Basket Folding Racks

Folding racks consisting of four parts that are located on the lower basket of your machine are designed in order to let you place big items easier such as pots, pans, etc. If requested, each part can be folded separately, or all of them can be folded and larger spaces can be obtained.

You can use folding racks by raising them upwards, or by folding.

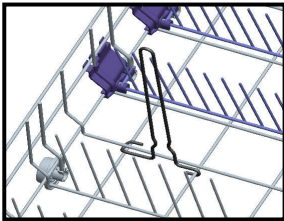
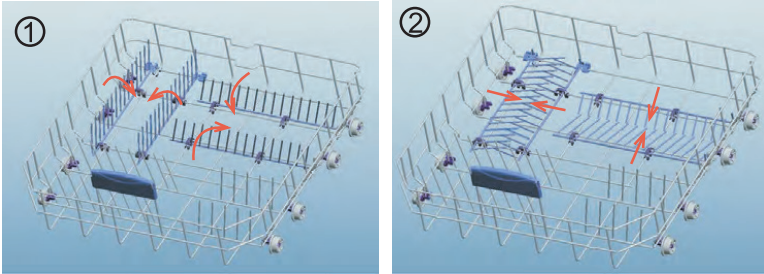

Bottle Rack

Bottle rack is designed to let you wash items with large openings and higher items easier. You can pull out bottle rack in the direction of the arrow as shown on the picture when you do not use it.

Multi-functional Rack System

Multi-functional rack system is located in the bottom basket of your machine. You can easily wash spare glasses or dishes like long ladles, bread knife with the help of this accessory.

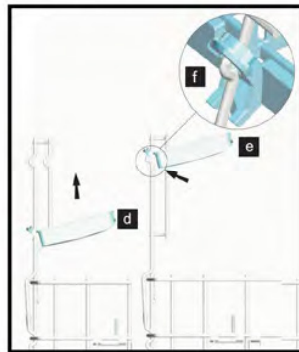
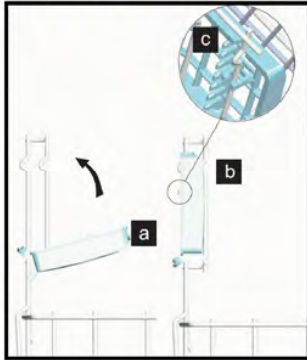
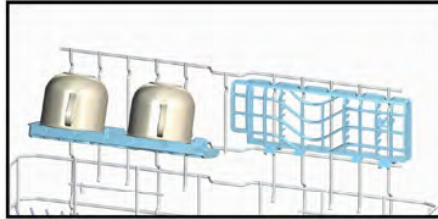
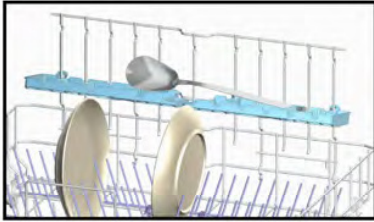

Please fold the racks by putting them from **a** position to **b** position, in order to put the racks in the multi-functional rack system into the closed position. Please make sure that claws on the rack are fit on the cord **c**. You can put the rack into the open position by following the steps in a reverse manner.

Your racks in the multi-purpose rack system has two positions: low position **d** and upper position **e**. This way you can attain larger space at the bottom part of your machine. Please put your racks into **e** position from **d** position to **e**, in order to put your racks to the upper position. Please fix the racks to their places **f** on the cord. Please make sure that the prop does not contact the dishes you put on the racks.

Upper Cutlery Basket

The upper cutlery basket is designed for you to place forks, spoons and knives, long dippers and small items.

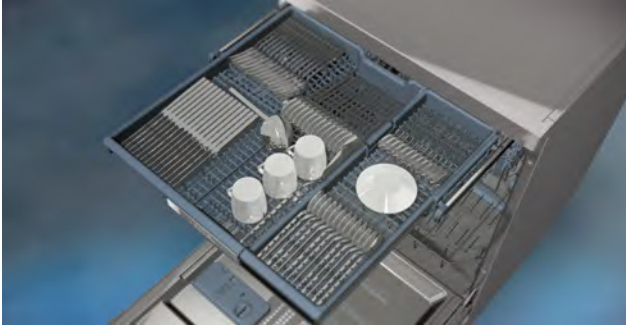

Because it can easily be taken out of the machine, it allows your dishes to be taken out of the machine along with the basket after washing.

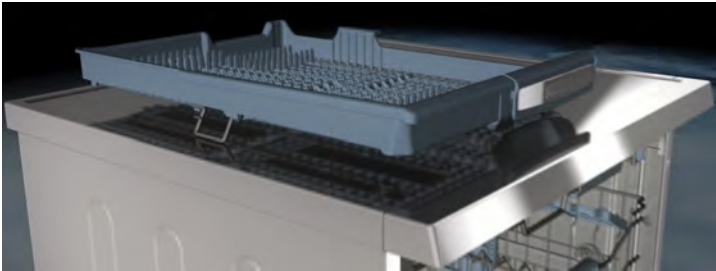

The Upper Cutlery Basket is composed of two pieces; if you need to make space for the dishes in the upper basket, you can take out the left or right part of the upper cutlery basket in order to obtain more space.



Warning: Knives and other sharp objects must be placed horizontally in the cutlery basket.

Alternative basket loads

Lower Basket

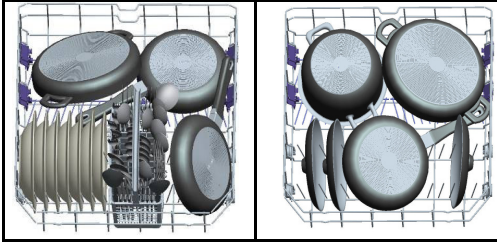

Top basket

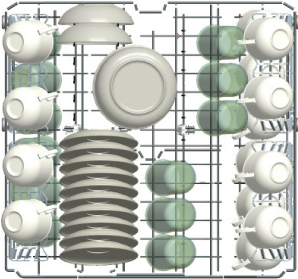

Faulty loads

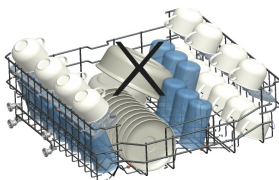
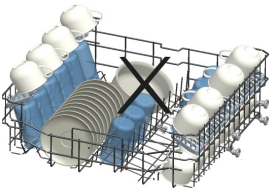
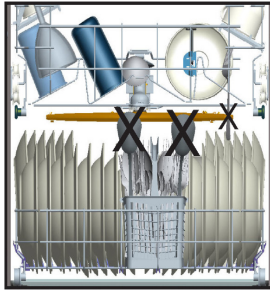
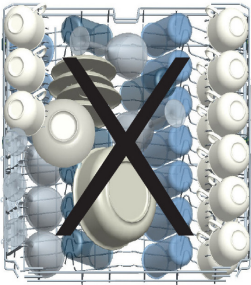

Program items

Programme names and temperatures	Mini 18' (P1)	Quick 30' 40°C(P2)	Eco (reference) 45°C Wash (P3)	* Dual Pro Wash 60°C (P4)	Super 50' 65°C (P5)	Hygiene 60°C (P6)	Auto Delicate 30-50°C	Auto intensive 50-70°C
Type of food waste	Pre-wash to rinse and loosen residue awaiting full load then select a programme	Coffee, milk, tea, cold meats, vegetables, not kept for long	Coffee, milk, tea, cold meats, vegetables , not kept for long	For both lightly soiled delicate glassware and heavily soiled crockery at the same time.	Soups, sauces, pasta, eggs, pilaf, potato and oven dishes, fried foods	Dishes with dense dirt, waiting for a long time or requiring hygienic washing	Auto program for normally soiled delicate dishes.	Auto program for heavily soiled dishes.
Level of soil	light		medium	medium	medium	heavy	medium	heavy
Detergent amount B:25cm ³ /15cm ³ A:5cm ³	A+B	A+B	A+B	A+B	A+B	A+B	A+B	A+B
	35°C Wash	40°C Wash	45°C Wash	40°C Wash	65°C Wash	60°C Wash	Washing step are determined automatically according to the amount of contamination.	
	45°C Rinse	Cold Rinse	Cold Rinse	65°C Wash	65°C Wash	65°C Wash		
	End	55°C Rinse	45°C Rinse	45°C Wash	65°C Rinse	Cold Rinse		
		End	Dry	65°C Rinse	End	50°C Wash		
			End	Dry		65°C Rinse		
			End	End		Dry		
Programme duration (min.)	18	30	138	112	50	154	77-91	124-179
Electricity consumption (kW hours)	0,57	0,88	0,65	1,43	1,29	1,75	0,81-0,96	1,22-1,8
Water consumption (liters)	7,7	10,9	12,2	15,4	10,7	18,5	10,6-17,7	12,3-24,6

Warning: Short programs do not include a drying step. The values declared above are the values obtained under laboratory conditions according to relevant standards. These values can change depending on conditions of product's use and environment (network tension, water pressure, water input temperature and environment temperature).

Warning: in Mini 18', Quick 30' and Super 50' 65°C programmes, there is no drying step. Values above have been tested according to related standards in lab condition. These values may vary due to environment conditions (mains voltage, water pressure, water inlet temperature and ambient temperature). **Eco 50° C values have been tested according to EnergySave option is selected. Open the door slightly 50mm to assist in drying of the dishes after every wash.

* Dual Pro Wash has advanced pump technology which allows for one wash to be cleaned at two separate water pressures. Baked on food doesn't stand a chance in the bottom while the delicate glasses in the top are gently being washed. I.E. the top rack is cleaned at a lighter wash pressure and the bottom rack at a higher water pressure.

Getting familiar with your machine

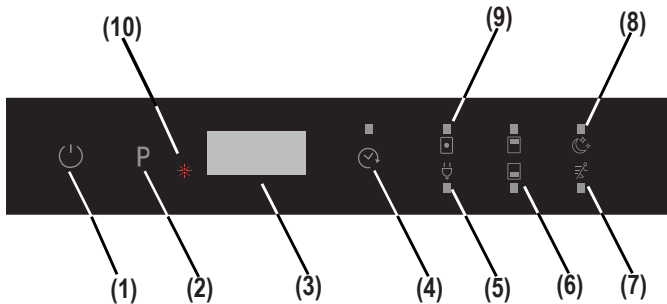

1.) Power On/Off Touch Button

When the Power On/Off touch is pressed, until touching any button, two dashes appear in the program display. The perceptivity of "On/Off touch button" is to be exactly 1 sec when touched by fingertip.

2.) Program Touch Button

With the Program touch button, you can select a suitable program for your dishes.

3.) Program Display

Program display indicates the times of the programs and the remaining time during the program flow. You can also follow-up the selected programs by this display.

4.) Delayed Start Touch Button

You can delay the start time of a selected program for 1-219 hours by pressing the Delayed start touch button of your machine. When you press the Delayed start touch button, delay "1h" appears on the program display. If you continue pressing the delay timer touch button, 1-2... 19 will be displayed respectively. You can activate the delayed start by selecting the delay time and the desired washing program with the Program touch button. It is also possible to select the program first and the delayed start afterwards, according to the last value entered.

You can also cancel Delayed start by choosing the delay timer as "0h" or hold the program touch button for 3 seconds. The display will inform you how many seconds you need to hold the button by "3-2-1..". This way, the delay countdown is cancelled.

Note: If user hold pressing continuously, delay timer starts counting faster (acceleration is proportional to the hold pressing time). In case of a long period of time pressed to Delayed start touch button, counter stops at " h:00".

5.)Energy Save Touch Button

Energy save option activates door opening system at the end of the program. Auto door opening system provides required drying performance at low rinsing temperatures and reduces energy consumption.

6.) $\frac{1}{2}$ Half Load Touch Button

Using the function $\frac{1}{2}$, three sorts of washing up can be done those being lower basket, upper basket and both baskets.

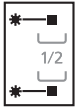

If you have little amount of dishes in your machine and if you have to wash them, you can also activate the semi-filling function in some of the programs additionally. If you have dishes in both baskets, press the key $\frac{1}{2}$ and select the position in which both lamps are highlighted.

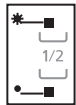

If you have dishes only in the upper basket, pres the key $\frac{1}{2}$ and select the position in which the upper lamp is illuminated. Thus, washing up shall be done only on the upper basket of your machine. No dishes should certainly be available in the lower basket while using this feature.



If you have dishes only in the lower basket, press the key $\frac{1}{2}$ and select the position in which the lower lamp is illuminated. Thus, washing up shall be done only on the lower basket of your machine. In using this feature, make sure that there are no dishes in the upper basket.

Note : If you have used an extra feature on the latest washing program, this feature will remain active also on the next washing program untill switch ON/OFF the machine. If you do not want to use this feature on the newly selected washing program, press the selected feature button again, and check that the lamp on the button goes off.

7.) Extra Fast Touch Button

Washes the dishes with more pressure, thus shortens the time of the selected program and provides economical water usage.

Note: This option can be selected only at the beginning of the program.

8.) Extra Silent Touch Button

Washes the dishes with less pressure, thus provides more sensitive and silent washing.

Note: This option can be selected only at the beginning of the program.

Note: When you select an incompatible program with the Extra silent & fast button, a buzzer sound is heard which indicates that the selected option is not compatible.

9.) Tablet Detergent Touch Button (3 in 1 button)

Press Tablet detergent touch button when you use combined detergents that include salt and rinse aid.

10.) Rinse aid Warning Indicator

In order to check that there is sufficient rinse aid in your machine check Rinse aid warning light on the display. When Rinse aid warning light starts coming on , fill in rinse aid chamber.

End of Program

Your machine gives a buzzer sound for “5 times” when the program is completed. When the door is opened after the selected washing program is completed , the buzzer activation will be ended and ‘0’ character is showed on display.

Note: Each energized of the machine, Eco program and Energy save option are set to as default and the options that are chosen before is cancelled. When user switch from Eco to other programs, Energy save icon become Off directly.

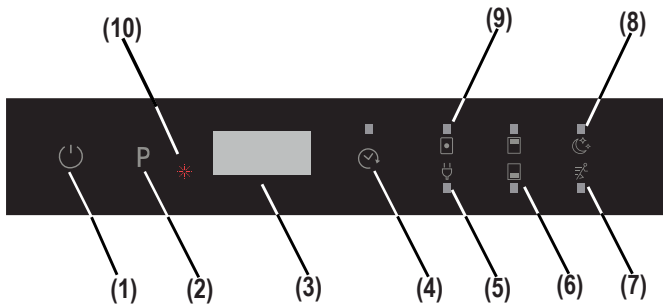

Switching on the machine

1- Touch the power On/Off key.

Machine is energized when the On/Off touch button **(1)** is pressed two dashes appear in the program display.

2- Select the program suiting your dishes via the Program touch button. **(2)**

When you select a program with the program touch button, **(2)** the program you select (P1,P2,etc) appears on the program display, **(3)** from (P1 to P8) and the duration of the program are alternatively visualized as 3 sec. P, 1 sec. duration time.

3- If you prefer or wish to prefer , you can choose additional function. **(4-9)**

4- Close door.The program starts automatically.

Note: If you decide not to start to machine after selecting the program , just press the on/off touch button. **(1)** Your machine will become ready for the new program selection when you press on/off touch button **(1)** again.You can select the new program by pressing the program touch button. **(2)** .

Program follow-up

- If you have a "InfoLED" function in your dishwasher model, you can follow the program via InfoLED. During machine is working you can see the light from InfoLED, when program is completed InfoLED turns off.

- When the door is opened after the selected washing program is completed, the buzzer activation will be ended and '0' character is showed on the display. **(3)**

- If the door is opened during washing cycle, remaining time of the selected program is also shown on the display. **(3)**

- Your machine also gives a buzzer sound for "5 times" when the program is completed.

Changing a program

If you would like to change programs while a washing program is continuing.

1- Open the door and select a new program by pressing the Program touch button. **(2)**

2- After closing the door, the selected new program will continue with the flux of the program but with the new parameters (temperature, cycles) of the new program.

Note: When the door of the machine is opened in order to stop the washing program before it is completed first open the door slightly in order to avoid water spillage.

Changing a program with resetting

If you would like to cancel a program while a washing program is resumed or standby position

1- Open the door of your machine. The last selected program will appear on the display. **(3)**

2- Keep the program touch button **(2)** pressed for 3 seconds. Meanwhile, Display **(3)** counts from “3 to 1” alternately and then shows “0:01” to indicate that cancelling is ready

3- Discharge process starts after closing the door of the machine. The machine discharges the water in it for about 30 seconds. When the program is cancelled, your machine gives a buzzer sound for “5 times “

Note: When the door of the machine is opened in order to stop the washing program before it is completed first open the door slightly in order to avoid water spillage.

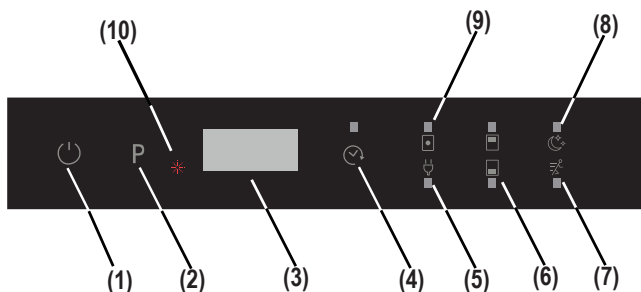

Switching the machine off

After program is completed ,you can switch your machine off by using the Power On/Off touch button. (1)

Note: After the buzzer sound which indicates the end of the program when the washing program comes to an end you can leave the door of your machine ajar in order to hasten the drying or you can select energy save option before starting a program to speed up your drying performance.

Note: If the machine door opens during washing or the power is cut off, the machine will go on to the program in case the door is shut or the power is back.

Program & option comparability

OPTIONS	Delayed Start	Half load (modes)	Tablet	Extra rinse
PROGRAMS				
Prewash	-	-	-	-
Quick 30' 40°C	X	X	-	X
Eco 50°C	X	X	X	X
Super 50' 65°C	X	X	X	X
Hygiene 60°C	-	-	-	-
Auto delicate 30°-50°C	X	X	X	X
Auto Normal 50°-60°C	X	X	X	X
Auto Intensive 60°-70° C	X	X	X	X

“-“ Function cannot be selected “x” function can be selected.
Extra fast and Extra silent can't be selected at the same time.

Turning on the Inner Light Option

1- Open the dishwasher door and press the Power On/Off touch button **(1)** to turn on the machine.

2- Press and hold both the "Tablet/Energy Save" and "Delayed start" **(4)** touch buttons simultaneously for 5 seconds

3- "IL0" will be shown on the display **(3)** for 2 seconds to indicate that the "Normal Mode" has been selected for the inner light option.

4- Once "Normal Mode" is selected, the inner light will be ON when the machine is powered on and the door is open.

Turning off the Inner Light Option

1- Open the dishwasher door and press the Power On/Off touch button **(1)** to turn on the machine.

2- Press and hold both the "Tablet/Energy Save" and "Delayed start" **(4)** touch buttons simultaneously for 5 seconds.

3- "IL1" will be shown on the display **(3)** for 2 seconds to indicate that the "Eco Mode" has been selected for the inner light option. Also the inner light turns OFF and ON again (blinks momentarily) to indicate that this selection is activated.

4- Once "Eco Mode" has been selected, the inner light will be ON for 4min and then turns OFF. If any user intervention occurs such as pressing touch buttons, Eco Mode cycle starts from beginning (inner light is ON for 4min and then turns OFF again)

Note: From the Factory the setting for the inner light is set to "IL1".

Buzzer sound set up

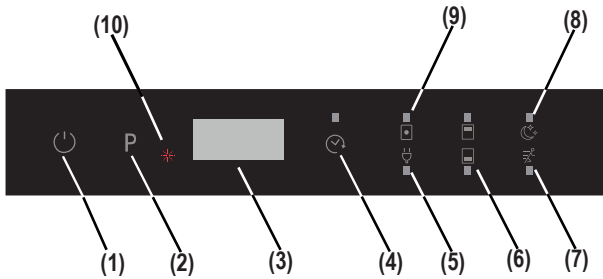

Buzzer set up can be adjusted arbitrarily.

1- Press the Power On/Off touch button". **(1)** (if it is in OFF position).
2- Pressurize to "Tablet/Energy Save" **(5)** and "Extra Fast/Silent". **(7,8)** touch buttons for 3 second at the same time to set the voice level.

3- While pressing "Tablet/Energy Save" **(5)** and "Extra Fast/Silent". **(7,8)** touch buttons (during 3 second.), display shows character of countdowning from 3 to 1.

- If voice controlling is done at first time, at the end of 3 seconds, "S03" is shown in the display.

- If voice controlling is done before, At the end of 5 seconds, last settled level is shown on the display (from "S00" to "S03").

The user can increase or decrease the voice level with "Tablet" and "Extra Fast/Silent". **(7,8)** touch buttons. The characters must be as follow;

- For increase the level of the buzzer sound

- 1) Press "Extra Fast/silent" touch button. **(5)**

- 2) Display **(3)** changes from "S00" to "S03"

- For decrease the level of the buzzer sound

- 1) Press "Tablet/Energy Save" touch button. **(5)**

- 2) Display **(3)** changes from "S03" to "S00". "S00" means that all buzzers are off

4- To exit voice control mode ,switch off the machine.

The last voice level that user determined before is stored in memory.

Note: From level sound "3" to "1", loudness level is reduced by stages depending on level sound.

MAINTENANCE AND CLEANING

Cleaning the machine in regular intervals prolongs the machine's service life.

Oil and lime may accumulate in the machine's washing section. In case of such accumulation;

-Fill the detergent compartment without loading any dishes into the machine, run the machine at high temperature. If this is not sufficient, use special cleansing materials.

Cleaning the seals in the machine door,

-Wipe the seals regularly by using a dampened cloth.

Cleaning machine,

Clean the filters and spray arms at least once a week.

Unplug your machine and turn off its tap before starting the cleaning.

Wipe with a fine cleaning material and a dampened cloth.

Filters

If any food wastes have remained on the coarse and fine filters, remove the filters and clean them thoroughly under the water tap.

a. Micro Filter

b. Coarse Filter

c. Metal/Plastic Filter

To remove and clean the filter combination, turn it counter clockwise and take it out by lifting upwards. **1**

Pull and remove the metal/plastic filter. **3** Then pull the coarse filter out of the micro filter. **2** Rinse it with lots of water under the tap. Refit the metal/plastic filter. Insert the coarse filter into the micro filter in a way that the marks will correspond to one another. Attach micro filter into the metal/plastic filter and turn to the direction of arrow and it is locked when the arrow on micro filter can be seen from across. **4**

- Never use your dishwasher without any filter.
- Incorrect fitting of the filter will reduce the washing effectiveness.
- Clean filters are very important in terms of the proper running of the machine.

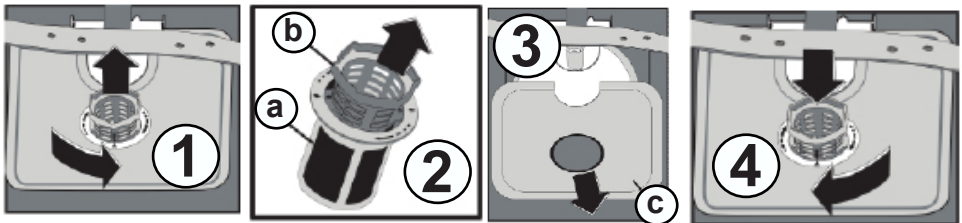

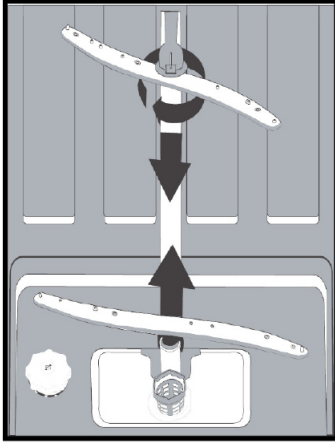

Spray arms

Check the holes for the upper and lower spray arms. If there is any clogging, remove the spray arms and clean them under water.

You can remove the lower spray arm by pulling it upwards, while the upper spray arm nut can be removed by turning the nut to the left. Be sure that the nut is perfectly tightened when refitting the upper spray arm.

Hose filter

Check the filter and the hose from time to time and clean them to prevent yellowing and formation of deposits after washing. To clean the filter, first turn off your tap and then remove the hose. After removing the filter from the hose, clean it under the tap. Insert the cleaned filter back into its place inside the hose. Refit the hose.

FAILURE CODES AND WHAT TO DO IN CASE OF FAILURE

ERROR CODE	ERROR DESCRIPTION	CONTROL
F5	Inadequate water supply	<ul style="list-style-type: none"> • Make sure the water input tap is totally open and that there is no water cut. • Close the water input tap, separate the water input hose from the tap and clean the filter at the connection end of the hose. • Restart your machine, contact the service if the error resumes.
F3	Error of continuous water input	<ul style="list-style-type: none"> • Close the tap. • Contact the service company.
F2	The waste water in the machine cannot be discharged.	<ul style="list-style-type: none"> • Water discharge hose is clogged. • The filters of your machine might be clogged. • Power off-on your machine and activate the program cancellation command. • If the error continues, contact the service.
F8	Heater error	<ul style="list-style-type: none"> • Contact the service company.
F1	Alarm is active against water overflow	<ul style="list-style-type: none"> • Power off your machine and close the tap. • Contact the service company.
FE	Faulty electronic card	<ul style="list-style-type: none"> • Contact the service company.
F7	Overheating error (temperature in the machine is too high)	<ul style="list-style-type: none"> • Contact the service company.
F9	Divisor position error	<ul style="list-style-type: none"> • Contact the service company.
F6	Faulty heater sensor	<ul style="list-style-type: none"> • Contact the service company.

If one of program monitor lights is on and start/Pause light is on and off,

Your machine's door is open, shut the door.

If the programme won't start

- Check if the plug is connected.
- Check your indoor fuses.
- Be sure that the water inlet tap is turned on.
- Be sure that you have closed the machine door.
- Be sure that you switched off the machine by pressing the Power On / Off button.
- Be sure that the water inlet filter and the machine filters are not clogged.

If the control lamps won't go out after a wash operation

The Power On/Off button is released yet.

If detergent residues are left in the detergent compartment

Detergent has been added when the detergent compartment was wet.

If water is left inside the machine at the end of the programme

- The water drain hose is clogged or twisted.
- The filters are clogged.
- The programme is not finished yet.

If the machine stops during a wash operation

- Power failure.
- Water inlet failure.
- Program can be on standby mode.

If shaking and hitting noises are heard during a wash operation

- Dishes placed incorrectly.

- Spray arm hitting the dishes.

If there are partial food wastes left on the dishes

- Dishes placed incorrectly into the machine, sprayed water did not reach related places.
- Basket overly loaded.
- Dishes leaning against one another.
- Very small amount of detergent added.
- An unsuitable, rather weak wash programme selected.
- Spray arm clogged with food wastes.
- Filters clogged.
- Filters incorrectly fitted.
- Water drain pump clogged.

If there are whitish stains on the dishes

- A very small amount of detergent is being used.
- Rinse aid dosage setting at a very low level.

If the dishes won't dry up

- A programme without a dry operation selected.
- Rinse aid dosage set too low
- Dishes unloaded too fast.

If there are rust stains on the dishes

- Stainless-steel quality of the dishes washed is insufficient.
- Unhealthy mains grounding.

Call an authorised service if the problem still persists after the controls or in case of any malfunction not described above.

PRACTICAL AND USEFUL INFORMATION

1. Whenever you will not be operating your machine

- Unplug the machine and then turn the water off.
- Leave the door slightly ajar in order to prevent the formation of unpleasant smells.
- Keep the machine interior clean.

2. Eliminating water droplets

- Wash the dishes with the intensive programme.
- Take all of the metal containers in the machine out.
- Do not add detergent.

3. If you properly place your dishes into the machine, you will be using it in the best way in terms

of energy consumption, washing and drying performance.

4. Clean all rough waste before you place dirty dishes to the machine.

5. Operate the machine after it is completely full.

6. Use pre-washing program only when necessary.

7. Observe program information and average consumption values table when selecting a

program.

8. Since the machine will reach high temperatures, it should not be mounted near refrigerator.

9. If the appliance is located in a place where the risk of freezing exists, you must completely drain the water that has remained in the machine. Turn off the water tap, disconnect the water inlet hose from the tap and allow the interior water to drain.



Award Appliances (NZ) Limited
E-mail: sales@award.co.nz
www.awardappliances.co.nz